

## 42 Clarke Drive GLADSTONE PARK VIC

5 3 3

You'll know the moment you step inside this family home that is stately in size, modern in appearance and prominent in location and it's made for the growing family.

**Type** : House

**View** : <https://www.jasonrealestate.com.au/sale/vic/north/gladstone-park/residential/house/7329620>

The immaculate interior offers flexibility and is the ideal large family home. An inviting living room leads through to well-appointed kitchen and meals area with new stainless steel appliances as well as separate dining room and a decked balcony overlooking parkland.

Upstairs offers your own private parents retreat with large master bedroom, birs, full ensuite and separate sitting room. Downstairs offers the versatility of independent living with 2 additional bedrooms, rumpus/lounge, kitchenette/meals and another bathroom - this is perfect for

[For full version visit the website](#)



Ground Floor

Disclaimer: Please note floor plans are indicative only not drawn to exact scale. All dimensions are approximate. Potential buyers should view the property in person.

42 Clarke Drive Gladstone Park

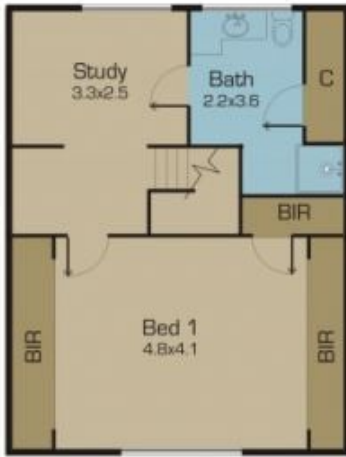

First Floor



Lower Ground Floor

42 Clarke Drive Gladstone Park