

## 4/2 Warwick Place TULLAMARINE VIC

3 2 2

Located at the entrance of the popular Gowanbrae Estate, this sophisticated and modern style townhouse was architectural designed by renowned KUD architects and offers the very best in quality and luxury living. As good as new this townhouse features a separate entrance with superior timber floors and high ceilings, gourmet kitchen with modern stainless steel appliances including Caesar Stone bench and breakfast bar, overlooking a generous family/meals area with access to a large courtyard. Upstairs there are three great sized bedrooms all with BIR's, main with ensuite bathroom, separate retreat/ living area and central bathroom. Furthermore there is a separate laundry, powder room, remote double garage with internal access, split system heating & cooling, gas cook top, electric oven, dishwasher and much more...

**Type** : House

**View** : <https://www.jasonrealestate.com.au/sale/vic/north/tullamarine/residential/house/7329621>



**Jason Sassine**  
03 9338 6411

[For full version visit the website](#)

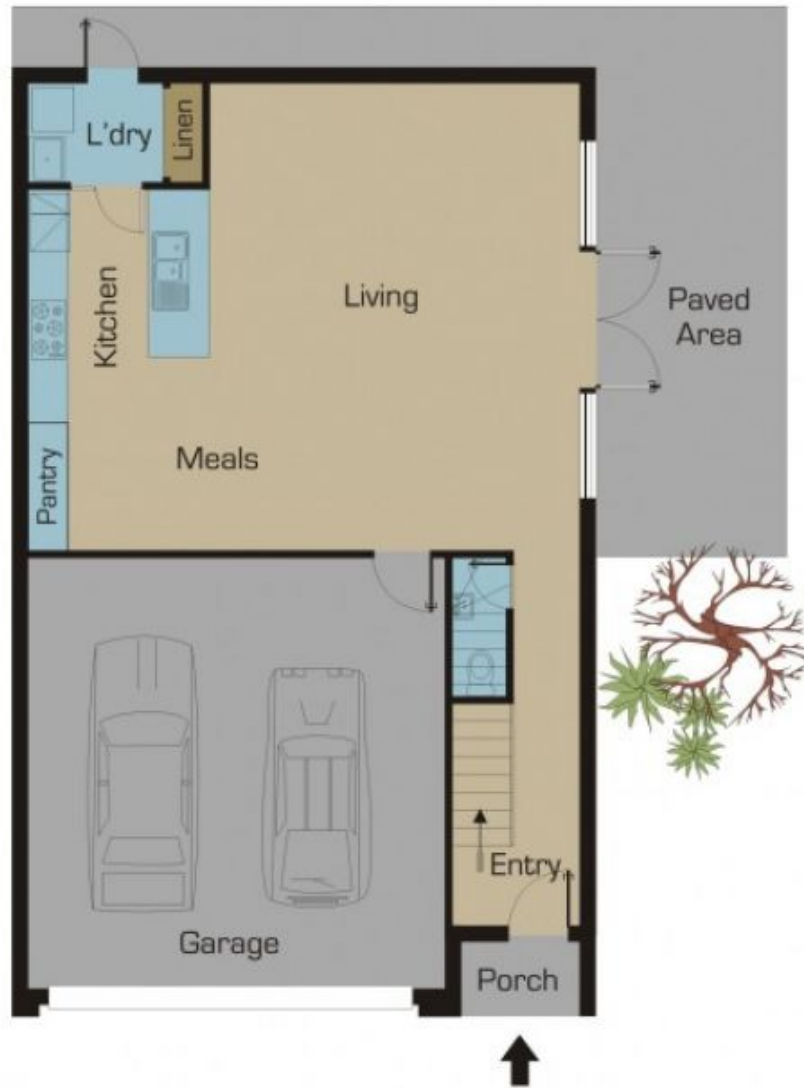

Ground Floor

Disclaimer: Please note floor plans are indicative only not drawn to exact scale. All dimensions are approximate. Potential buyers should view the property in person.

4/2 Warwick Place Tullamarine



First Floor

Disclaimer: Please note floor plans are indicative only not drawn to exact scale. All dimensions are approximate. Potential buyers should view the property in person.

4/2 Warwick Place Tullamarine