



Over 1 Acre of Land



8 Welburn Place GREENVALE VIC

3 2 13

A fantastic focus on premium quality, peacefulness and a real country feel Sprawled over an acre (4,500 sq. metres approx.) in one of Greenvale's exclusive and quietest pockets. This immaculate single level family residence, features a separate entrance foyer, formal and informal living zones including lounge/dining room, huge informal meals area plus a separate family/rumpus room, well-appointed kitchen with modern appliances, three great size bedrooms plus study/4th bedroom, full ensuite & WIR's to master bedroom, central bathroom with claw bath, roomy laundry plus a double garage with internal access. Step outside to magnificent under cover entertaining BBQ area that overlooks a heated spa and beautifully established gardens. A circular drive way for convenient access plus a side gated drive way access that leads to a

Type : House
Land Size : 4500 sqm
View : <https://www.jasonrealestate.com.au/sale/vic/north/greenvale/residential/house/7329647>



Jason Sassine
03 9338 6411

[For full version visit the website](https://www.jasonrealestate.com.au)

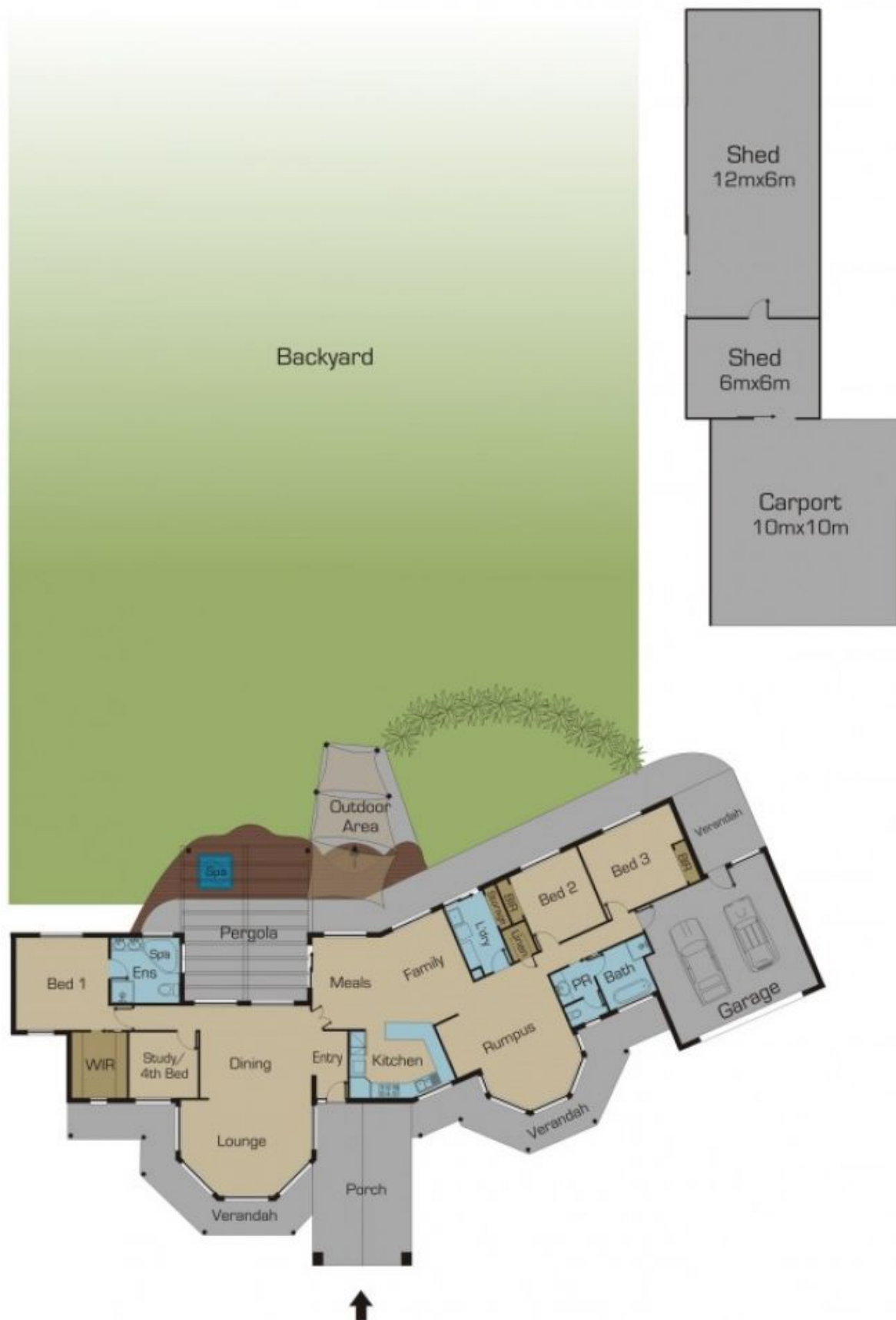

Disclaimer: Please note floor plans are indicative only not drawn to exact scale. All dimensions are approximate. Potential buyers should view the property in person.

8 Welburn Place Greenvale