



28 Fluent Lane GREENVALE VIC

3 3 2

Impressive with its design and boasting first class fixtures and finishes throughout this distinctive home delivers a luxurious low-maintenance lifestyle. Nestled in the popular Greenvale Aspect estate, this stunning home is built with "no short cuts taken" and ready for a new family to simply move in and start living! Positioned perfectly facing Destination Park, this two-level home measuring 22 squares approx. offers you comfort, open space and a luxurious feel from the moment you enter.

The lower level introduces a main bedroom with full en-suite and walk in robe, designer kitchen fitted with Miele appliances and glass splashback, walk in pantry and stone benchtops whilst overlooking the sizeable meals / family room. Making your way up the staircase, you will discover a

Type : House
Land Size : 200 sqm
View : <https://www.jasonrealestate.com.au/sale/vic/north/greenvale/residential/house/7330018>



Jason Sassine
03 9338 6411

[For full version visit the website](https://www.jasonrealestate.com.au)

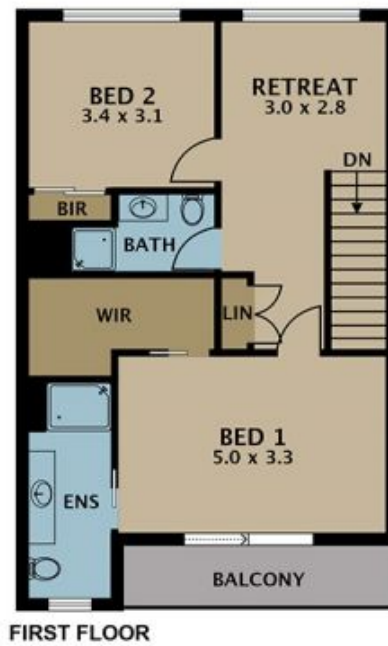
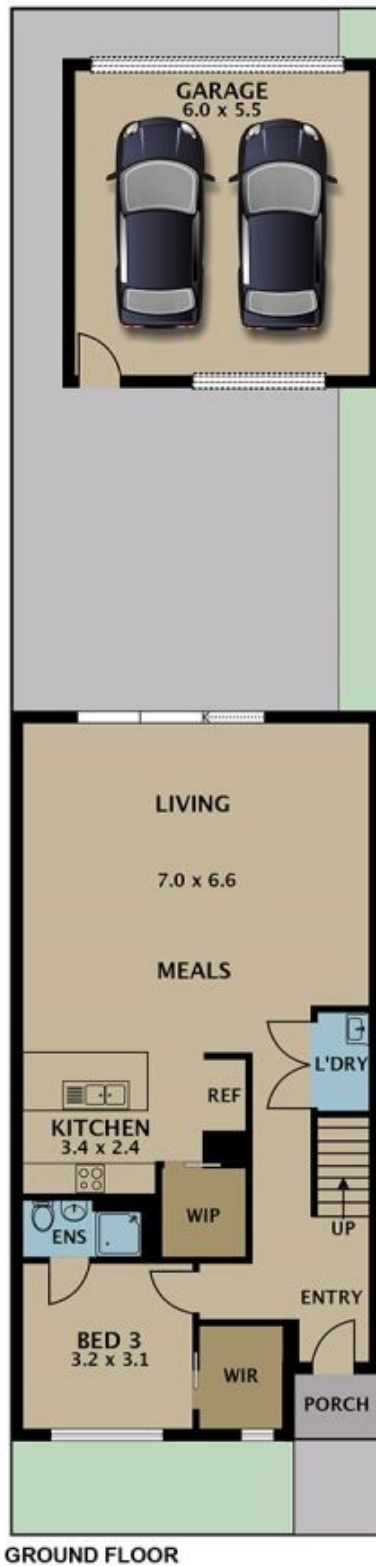

Disclaimer. Please note plans are indicative only and not drawn to exact scale. All dimensions are approximate. Potential buyers view the property in person.

28 Fluent Lane Greenvale