



**23/226 Melrose Drive TULLAMARINE VIC**

1 1 1

Ideal for first home buyers, downsizers or investors is this unique opportunity to secure a very affordable property conveniently located in the heart of Tullamarine offering easy access to freeways, Melbourne Airport and Westfield Shopping Centre.

**Type** : Villa

**View** : <https://www.jasonrealestate.com.au/sale/vic/north/tullamarine/residential/villa/7330020>

This low maintenance, ground floor unit consists of a secure front entry, large bedroom with BIR, combined bathroom/laundry, well-equipped kitchen with stainless steel appliances and comfortable living area. Features split system heating & cooling, Alfresco entertaining area, timber deck area courtyard & single carport plus visitor car-park directly out the front.

Inspect now

[For full version visit the website](https://www.jasonrealestate.com.au)

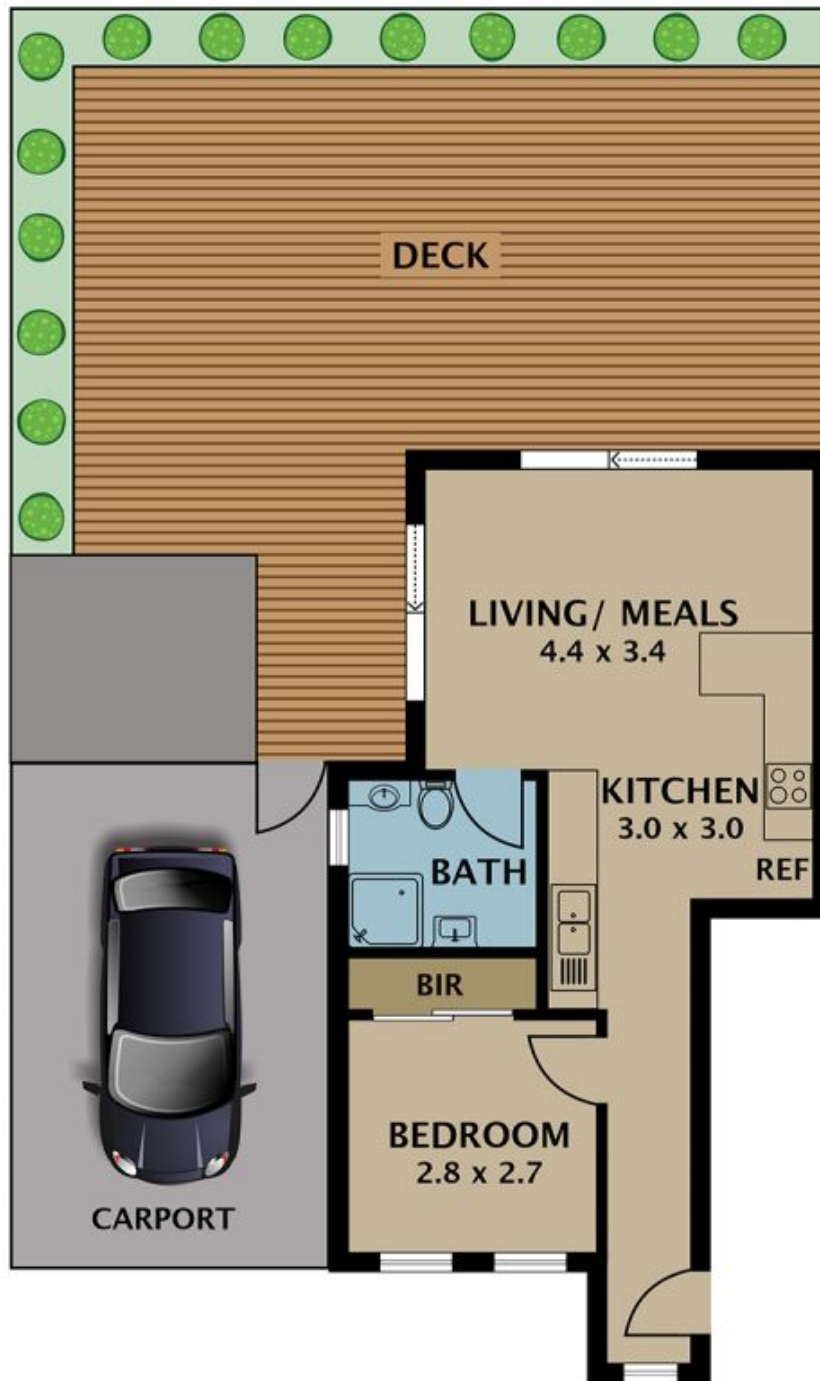

Disclaimer. Please note plans are indicative only and not drawn to exact scale. All dimensions are approximate. Potential buyers view the property in person.

23/226 Melrose Drive Tullamarine