



7 Piccadilly Court GREENVALE VIC

4 🏠 2 🚗 3 🚗

This stunning residence Quietly nestled in the heart of original Greenvale on an allotment of approx over 760 m2 within close proximity to schools, Greenvale shop/ cafes, parkland and public transport this spacious home boasts a demanding presence with great views.

The versatile floor plan offers high ceilings with superior timber flooring throughout, beaming with natural light this home will engage you with its appealing outlook and stylish finishes. Upon entry be greeted with formal living and dining zones, renovated kitchen with ample cupboard space and equipped with a full range of quality appliances with adjoining meals area overlooking a separate family room which extends to a balcony offering amazing views. All bedrooms are well proportioned and include built-in robes with an updated central bathroom to service, whilst

Type : House
Price : \$ 880,000
Land Size : 760 sqm
View : <https://www.jasonrealestate.com.au/sale/vic/north/greenvale/residential/house/7330063>



Jason Sassine
03 9338 6411

[For full version visit the website](https://www.jasonrealestate.com.au)

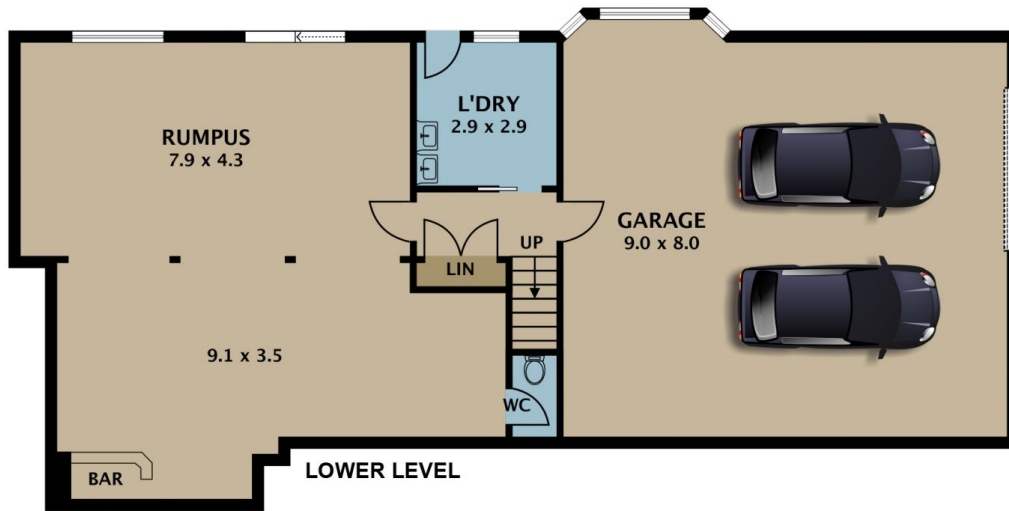

Disclaimer. Please note plans are indicative only and not drawn to exact scale. All dimensions are approximate. Potential buyers view the property in person.

7 Piccadilly Court Greenvale

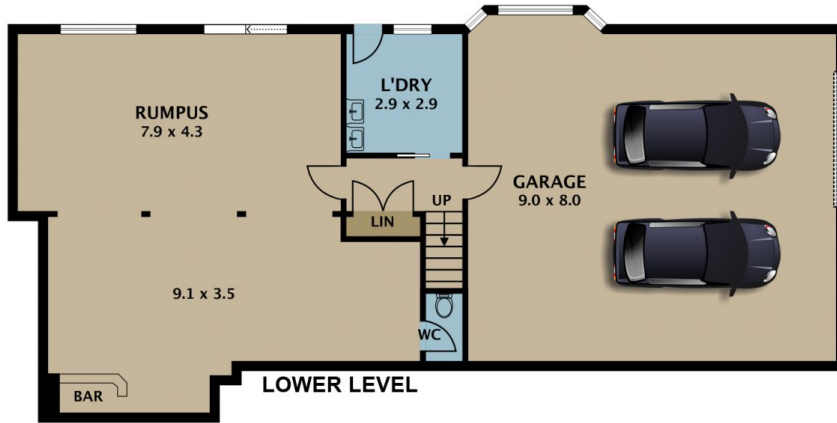

Disclaimer. Please note plans are indicative only and not drawn to exact scale. All dimensions are approximate. Potential buyers view the property in person.

7 Piccadilly Court Greenvale