



## 9 Waverley Court GLADSTONE PARK VIC

4  1  2 

Tucked away at the end of a quiet cul-de-sac in the heart of Gladstone Park within easy walking distance of quality schools, parks, library, sporting facilities and shopping centre; is this double-storey brick veneer and tile family home on a fully fenced 597m<sup>2</sup>.

Across two levels; the three bedrooms and bathroom with separate toilet are on the upper level, whilst the formal lounge, study/fourth bedroom, dining, large kitchen, powder room, expansive covered alfresco entertaining deck, and laundry are on the ground floor, along with double lock up garage and storage.

Gas ducted heating, evaporative cooling, stainless steel appliances, gas cooktop, breakfast bar, spa bath, floating

[For full version visit the website](https://www.jasonrealestate.com.au)

**Type** : House  
**Land Size** : 597 sqm  
**View** : <https://www.jasonrealestate.com.au/sale/vic/north/gladstone-park/residential/house/7330137>



**Jason Sassine**  
03 9338 6411



GROUND FLOOR

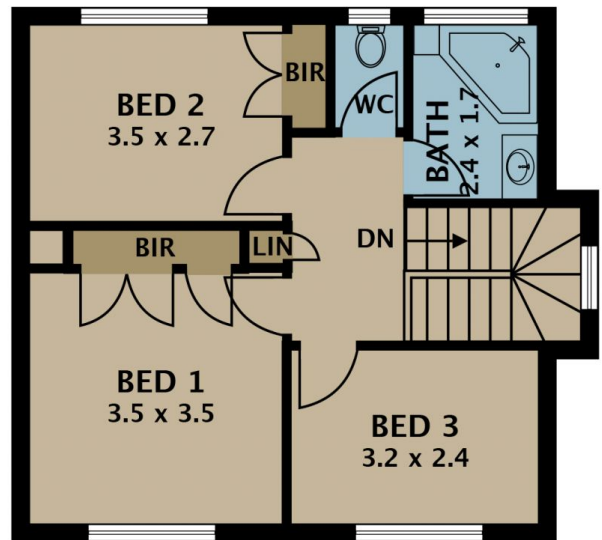

FIRST FLOOR

Disclaimer. Please note plans are indicative only and not drawn to exact scale. All dimensions are approximate. Potential buyers view the property in person.

# 9 Waverley Court Gladstone Park