

19 Wallace Drive GREENVALE VIC

4 3 2

A home with so much to offer: three levels of beautifully designed living space, a great location in old Greenvale with leafy park views, and an opportunity to create a flexible living arrangement.

A grand entrance greets you on the ground floor, leading you to a spacious and beautifully styled formal lounge that boast high ceilings with decorative elements, columns, and double French doors, creating a stylish and comfortable living area to relax in. The formal lounge flows to the open plan living, meal and kitchen. Completing the level is a spacious study room, perfect for working from home.

Capitalising on the north-easterly aspect, wall-to-wall full-length windows flood the living space with natural light

Type : House
Land Size : 553 sqm
View : <https://www.jasonrealestate.com.au/sale/vic/north/greenvale/residential/house/7330273>



Jason Sassine
 03 9338 6411

[For full version visit the website](https://www.jasonrealestate.com.au)

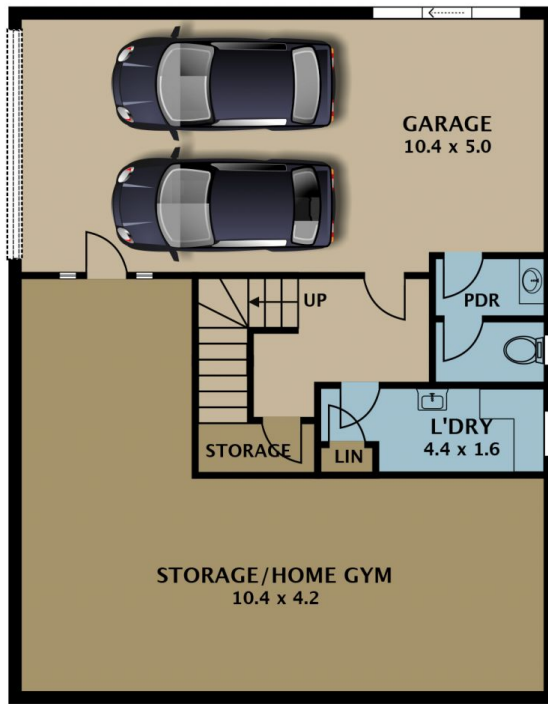

LOWER LEVEL

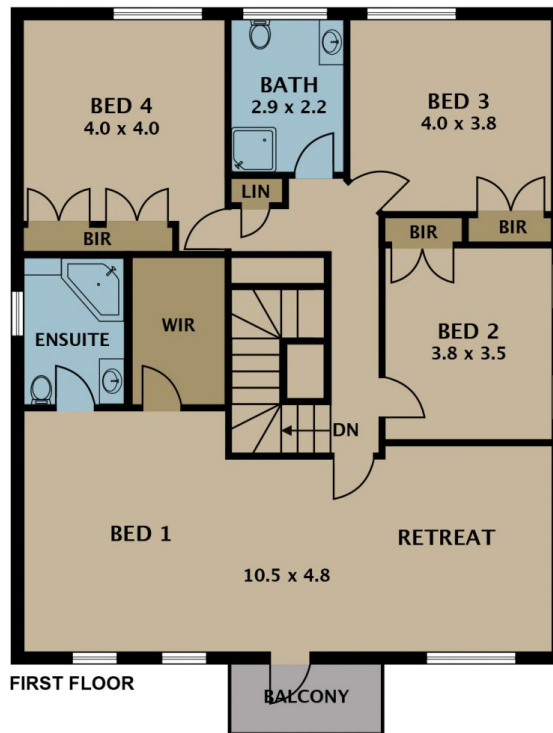

FIRST FLOOR

Disclaimer. Please note plans are indicative only and not drawn to exact scale. All dimensions are approximate. Potential buyers view the property in person.

19 Wallace Drive Greenvale



GROUND FLOOR

Disclaimer. Please note plans are indicative only and not drawn to exact scale. All dimensions are approximate. Potential buyers view the property in person.

19 Wallace Drive Greenvale