



## 40 Providence Road GREENVALE VIC

Spread over 2.2 hectares approx. (5.5 acres approx.), this magnificent piece of real estate is PSP approved for residential subdivision (STCA) and offers a golden opportunity to purchase a residential subdivision development (STCA) with a two street frontage to Providence Road and Carroll Lane.

Secluded behind remote front gates this fully renovated 3 bedroom dwelling with ensuite to master, gourmet kitchen overlooking meals and living area plus a separate rumpus room. A detached pool house adjoins a private in ground swimming pool and a magnificent undercover entertaining area, plus stable/storage and huge shed with remote doors.

**Type** : Development  
**Land Size** : 21958 sqm  
**View** : <https://www.jasonrealestate.com.au/sale/vic/north/greenvale/commercial/development/7331013>

[For full version visit the website](https://www.jasonrealestate.com.au)

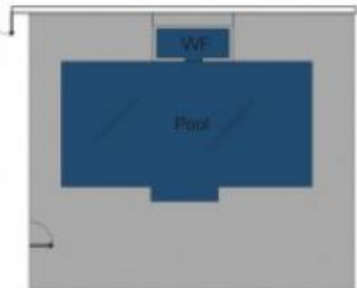
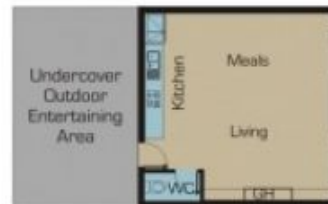
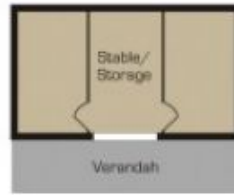

Disclaimer: Please note floor plans are indicative only not drawn to exact scale. All dimensions are approximate. Potential buyers should view the property in person.

40 Providence Road Greenvale