



## 730 Craigieburn Road MICKLEHAM VIC

Located on a prime 6.9acre parcel of land on corner block with two-street access is this custom-designed and built residence on the grandest of scales at over 120 squares; approximately 80-90% complete, there is some finishing off for purchaser to do, mostly installing fixtures and fittings as well as external works.

Designed with several wings, the floor plan is expansive and offers versatile options; altogether the home is complete with five bedrooms, three bathrooms plus powder room, two kitchens including commercial grade cool room, multiple living areas for formal and casual entertaining, theatre, gymnasium, alfresco entertaining, and massive six car garage plus storage.

<b>Type</b>	: Development
<b>Land Size</b>	: 27600 sqm
<b>View</b>	: <a href="https://www.jasonrealestate.com.au/sale/vic/north/mickleham/commercial/development/7331040">https://www.jasonrealestate.com.au/sale/vic/north/mickleham/commercial/development/7331040</a>

[For full version visit the website](https://www.jasonrealestate.com.au)

<https://www.jasonrealestate.com.au>

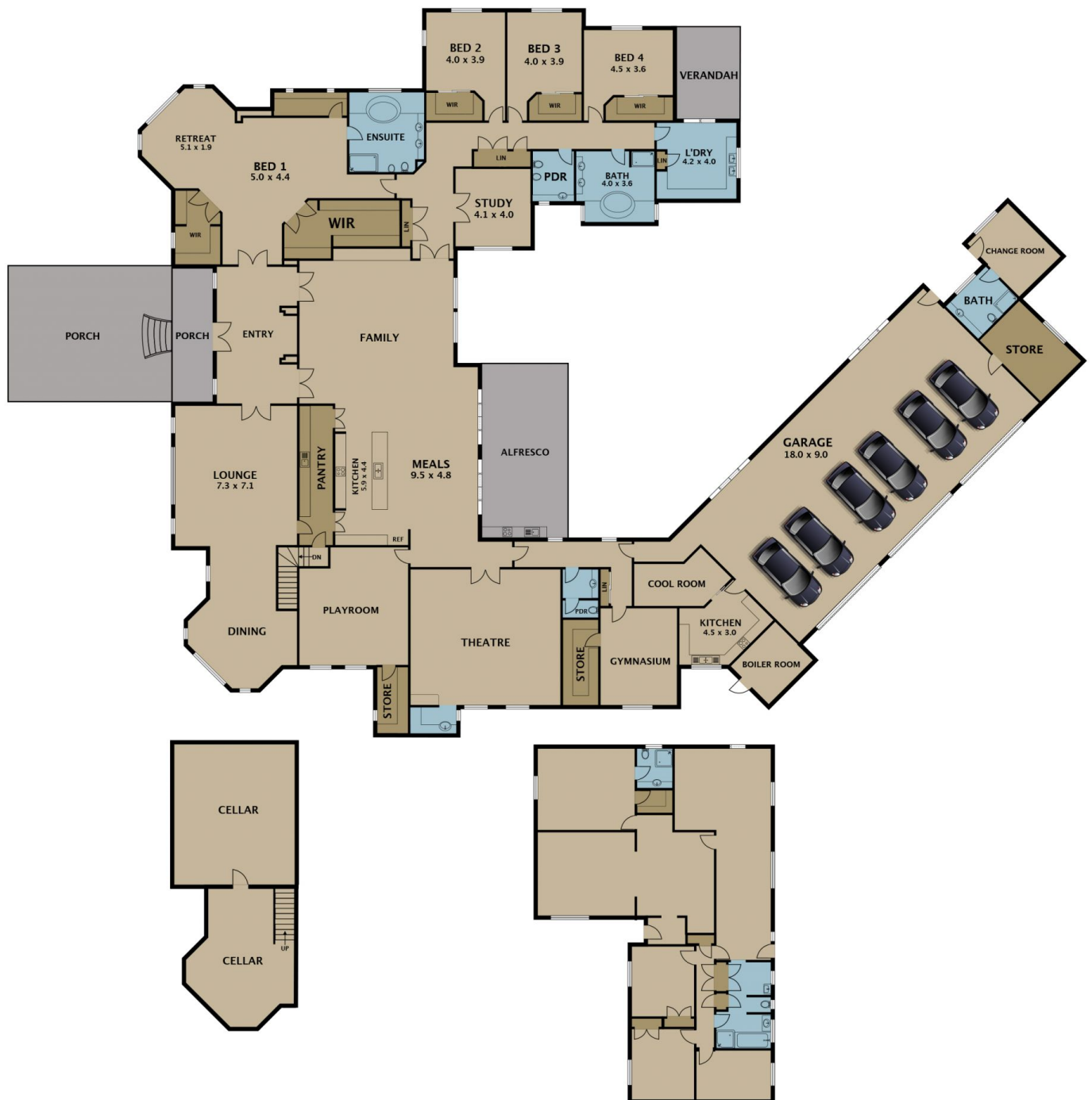

Disclaimer. Please note plans are indicative only and not drawn to exact scale. All dimensions are approximate. Potential buyers view the property in person.

# 730 Craigieburn Road Yuroke

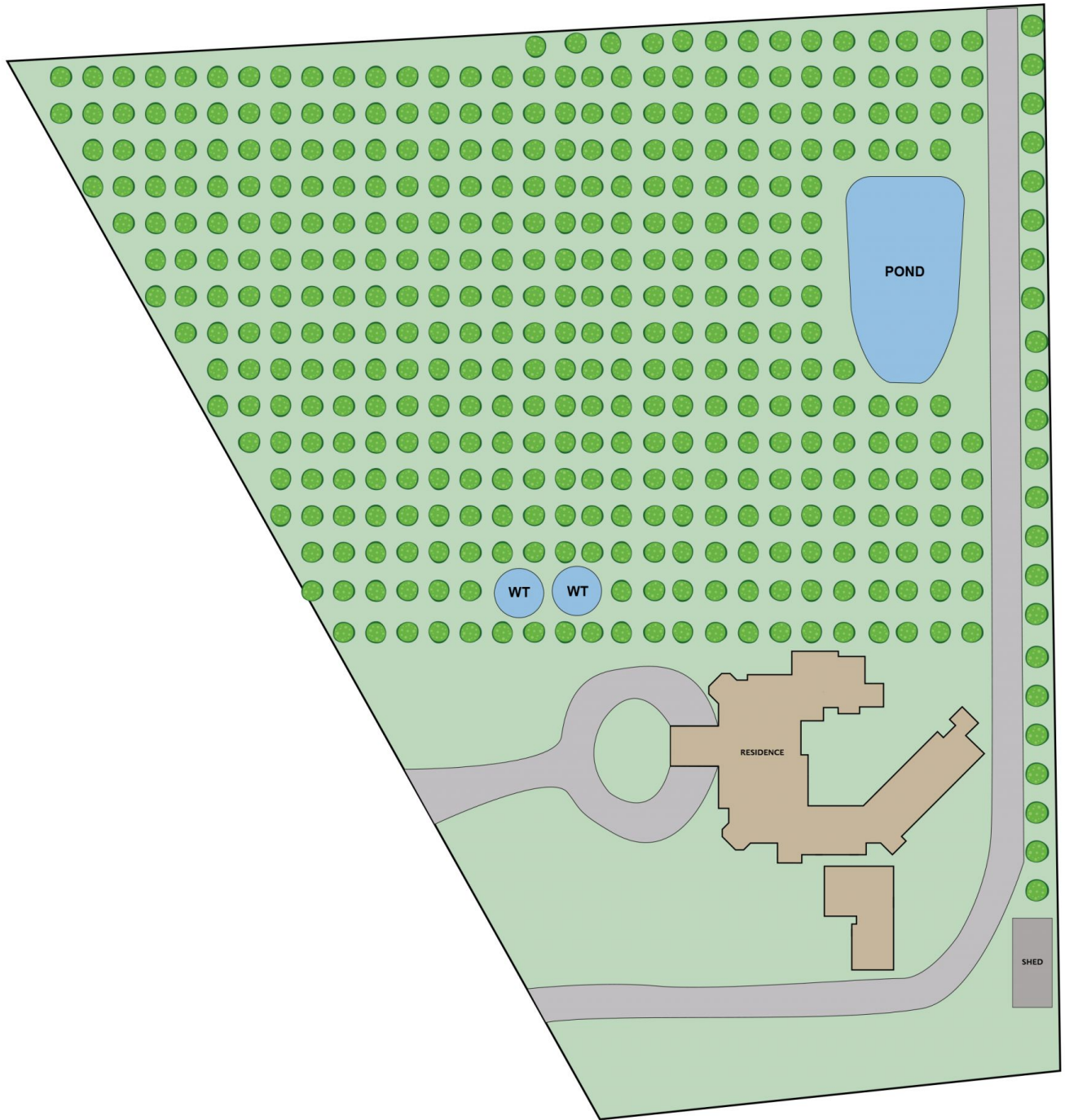

Disclaimer. Please note plans are indicative only and not drawn to exact scale. All dimensions are approximate. Potential buyers view the property in person.

# 730 Craigieburn Road Yuroke