



**JASON**  
commercial

Leo Kikyris  
0408 365 860

Commercial/Industrial  
Division Manager

List your investment property with me today



## 4/25 Beverage Drive TULLAMARINE VIC

5 🚗

Jason Real Estate Commercial is pleased to offer 4/25 Beverage Drive, Tullamarine for sale via expressions of interest, closing 5PM Thursday 18th August 2022.

Modern dual level offices, with adjoining warehouse space within a corporate location, close distance from the Melbourne Tullamarine Airport (MEL), and easy access onto the Western Ring Road and Calder Freeways.

Property is to be sold with vacant possession, however this property provides a GREAT opportunity for the savvy investor to secure a commercial asset with possibility to obtain a dual tenancy income; by way of leasing ground floor and level 1 areas to separate tenancies.

**Type** : Offices  
**Building Size** : 390 sqm  
**Land Size** : 297 sqm  
**View** : <https://www.jasonrealestate.com.au/sale/vic/north/tullamarine/commercial/offices/7331065>



Leo Kikyris  
03 9304 1444

[For full version visit the website](https://www.jasonrealestate.com.au)

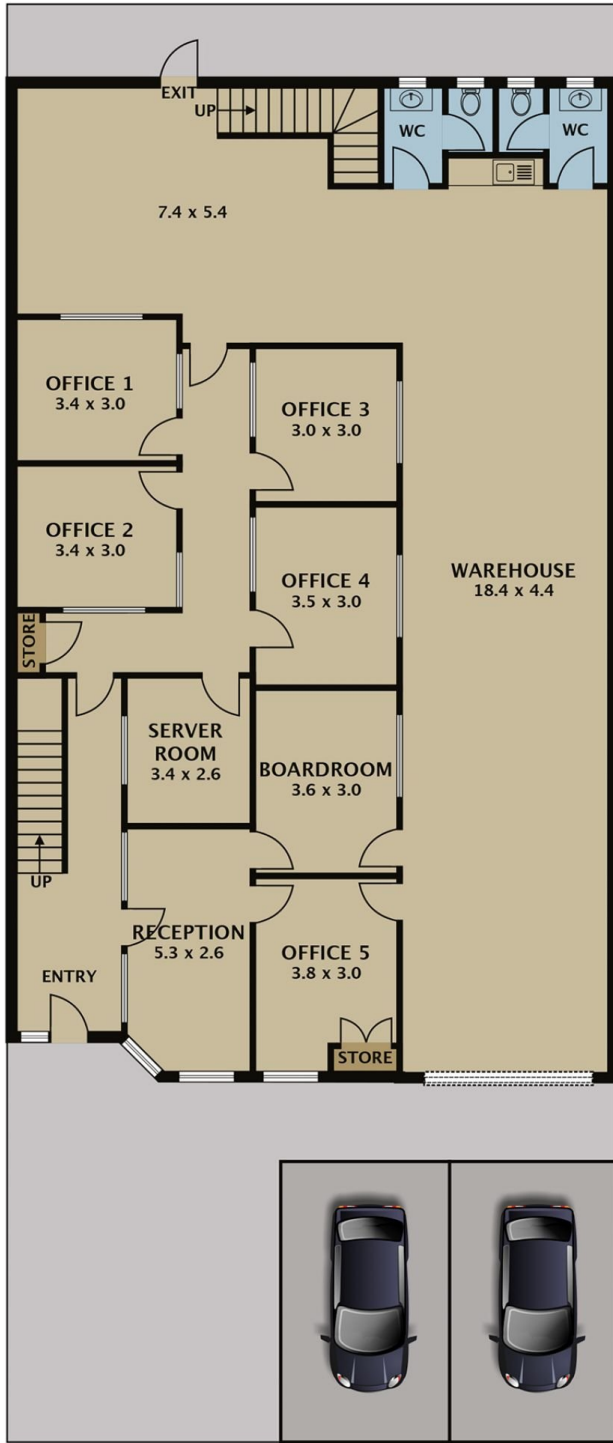

**GROUND FLOOR**

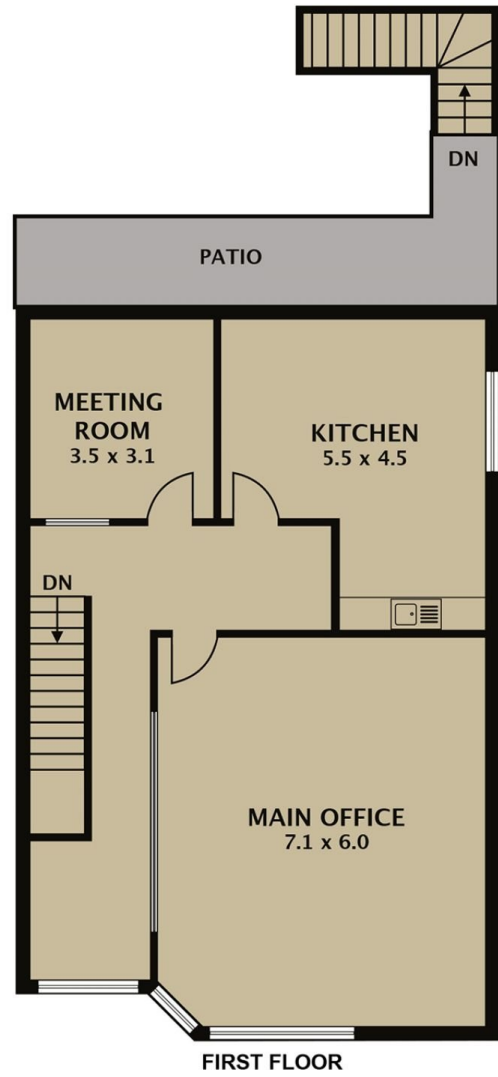

**FIRST FLOOR**

Disclaimer. Please note plans are indicative only and not drawn to exact scale. All dimensions are approximate. Potential buyers view the property in person.

# 4/25 Beverage Drive Tullamarine