



## 28 Fluent Lane Greenvale VIC

3 3 2

A fantastic opportunity to acquire this near-new townhome with no body corporation in Greenvale. Flawlessly presented both inside and out, this home offers a low-maintenance family lifestyle, perfect for first home buyers or investors.

Impressive with its design and boasting first class fixtures and finishes throughout this distinctive home delivers a luxurious low-maintenance lifestyle. Nestled in the popular Greenvale Aspect estate, this stunning home is built with "no short cuts taken" and ready for a new family to simply move in and start living! Positioned perfectly facing Destination Park, this two-level home measuring 22 squares approx. offers you comfort, open space and a luxurious feel from the moment you enter.

[For full version visit the website](https://www.jasonrealestate.com.au)

**Type** : Townhouse  
**Price** : \$ 625,000  
**Land Size** : 202 sqm  
**View** : <https://www.jasonrealestate.com.au/sale/vic/north/greenvale/residential/townhouse/7338773>



**Jason Sassine**  
03 9338 6411



**Maria Pais**  
03 9338 6411

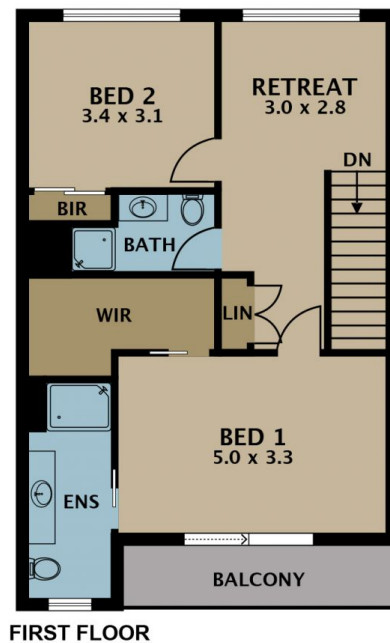

Disclaimer. Please note plans are indicative only and not drawn to exact scale. All dimensions are approximate. Potential buyers view the property in person.

# 28 Fluent Lane Greenvale