

4/46 Allied Drive Tullamarine VIC

3

Leo Kikyris & Steve Kikyris of Jason Commercial are pleased to offer for lease to the public market: 4/46 Allied Drive, Tullamarine.

Generously sized warehouse/office space located conveniently on Allied Drive. Property provides easy access to all nearby major arterial roads such as Sharps Road, Airport Drive, Western Ring Road, Citylink and close proximity to the Melbourne (MEL) and Essendon Fields Airport/s (MEB).

KEY FEATURES INCLUDE:

- * Building area: 300 m2 (approx)
- * 3 Car parking spaces
- * Industrial 1 zone

[For full version visit the website](https://www.jasonrealestate.com.au)

Type : Industrial
Building Size : 300 sqm
Land Size : 300 sqm
View : <https://www.jasonrealestate.com.au/lease/vic/north/tullamarine/commercial/industrial/7757874>



Leo Kikyris
03 9304 1444



Steve Kikyris
03 9304 1444

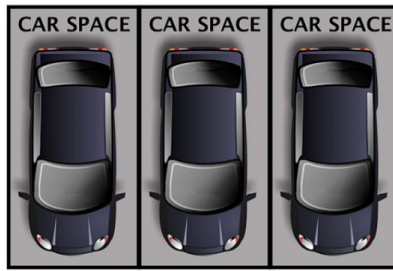

(NOT IN POSITION)

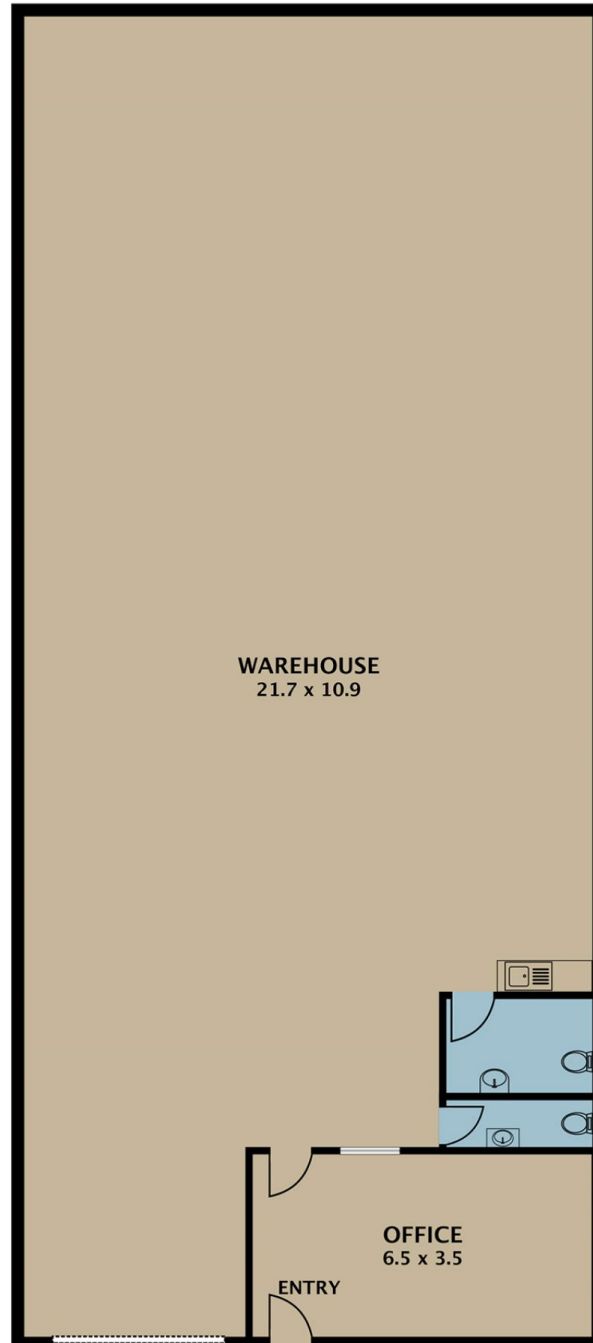

Disclaimer. Please note plans are indicative only and not drawn to exact scale. All dimensions are approximate. Potential buyers view the property in person.

4/46 Allied Drive Tullamarine