



30 Allied Drive Tullamarine VIC

Leo & Steve Kikyris of Jason Real Estate Commercial are pleased to offer for sale to the public market: 30 Allied Drive, Tullamarine.

Open clear span warehouse, with small adjoining office space creates the perfect mix for any small to medium business operator looking to take the next step.

KEY FEATURES INCLUDE:

- * Land area: 400m2
- * Building area: 330m2
- * Power capacity supply (3-Phase)
- * Large roller door entrance
- * 5 Secure parking bays

[For full version visit the website](https://www.jasonrealestate.com.au/sale/vic/north/tullamarine/commercial/industrial/8125600)

Type	: Industrial
Price	: Contact Agent
Building Size	: 330 sqm
Land Size	: 400 sqm
View	: https://www.jasonrealestate.com.au/sale/vic/north/tullamarine/commercial/industrial/8125600



Steve Kikyris
03 9304 1444



Leo Kikyris
03 9304 1444

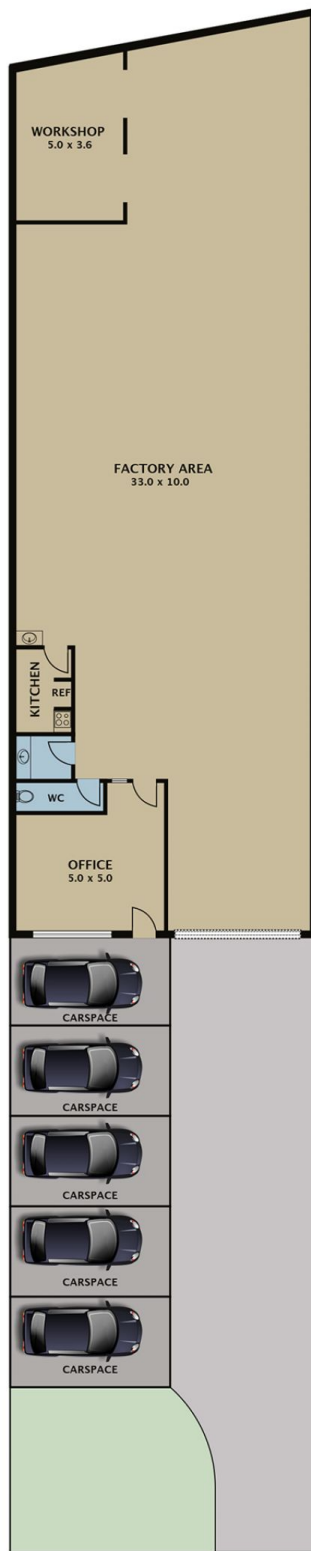

Disclaimer. Please note plans are indicative only and not drawn to exact scale. All dimensions are approximate. Potential buyers view the property in person.

30 Allied Drive Tullamarine